

**State of Wyoming Corner Record**

(In compliance with the CORNER PERPETUATION and FILING ACT, Wyoming Statutes, 1997,  
Section 33-29-140, et seq., and the rules and regulations of the Board of Registration  
for Engineers and Professional Land Surveyors)

The reverse side of this form may be used if more space is needed.

*The Record of the original survey and the citation of the source of the historical information (if the corner is lost or obliterated). The description of the corner monumentation evidence as found and/or the monument and it's accessories as established to perpetuate the location of this corner. A sketch of the relative location of this Monument, accessories, and reference points with the course and distance to adjacent corner (s) (if determined during this Survey). The Method and Rationale used for the reestablishment of lost and obliterated corner.*

Note: This point was not set during the original GLO survey of this Section when this Township was surveyed.

The CE 1/16 Corner of Section 30 was established proportionally at the mid point between the Center 1/4 of Section 30 and the 1/4 corner common to Section 30 and Section 29. This point was established and Monumented utilizing a 5/8 X 32" rebar with a 1-1/2" Aluminum Cap and tied from pk nails in the gate postand the fence corner post and a tie from a steel piope fence post as shown hereon.



RECORDED 5/23/2007 AT 4:20 PM REC# 475717 BK# 2008 PG# 1719  
DEBRA K. LATHROP, CLERK OF LARAMIE COUNTY, WY PAGE 1 OF 1

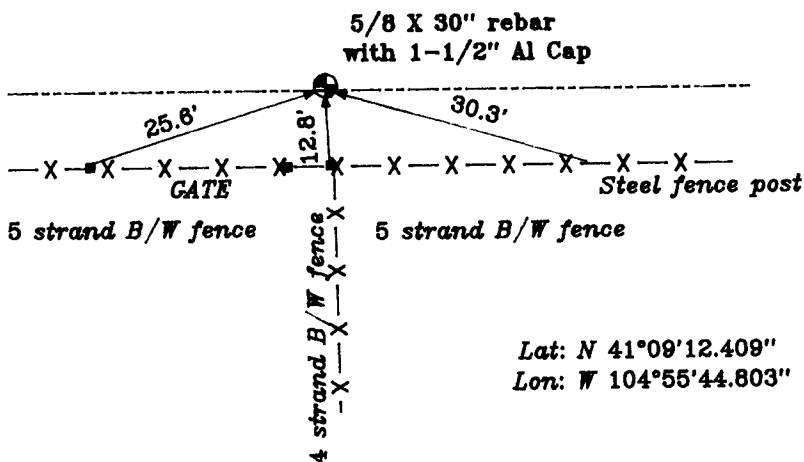

Lat: N 41°09'12.409"  
Lon: W 104°55'44.803"

Date of Field Work: May 2007 Office Reference: Cox Ranch

**Cross Index Diagram**

T.14 N. R.67 W. 6th P.M.

1	2	3	4	5	6	7	8	9	10	11	12	13	14	15	16	17	18	19	20	21	22	23	24	25
A																								
B																								
C																								
D																								
E																								
F																								
G																								
H																								
J																								
K																								
L																								
M																								
N																								
O																								
P																								
Q																								
R																								
S																								
T																								
U																								
V																								
W																								
X																								
Y																								
Z																								

Firm/Agency, Address  
**Terrestrial Surveying & Mapping Co.**  
*"Your Friendly Neighborhood Surveyor"*  
 1127 Terry Ranch Road  
 Cheyenne, Wyoming 82007  
 Telephone Number: (307) 634-9360

This Corner Record was prepared by me or under my direction and supervision.

SEAL & SIGNATURE

